



PARSHVANATH

Limitless Luxury



RERA NO. : RAJ/P/2025/3460



UNPARALLELED, EXTRAORDINARY



AND EVERY THING IN BETWEEN

THE WARMEST WELCOME TO THE PINK CITY,

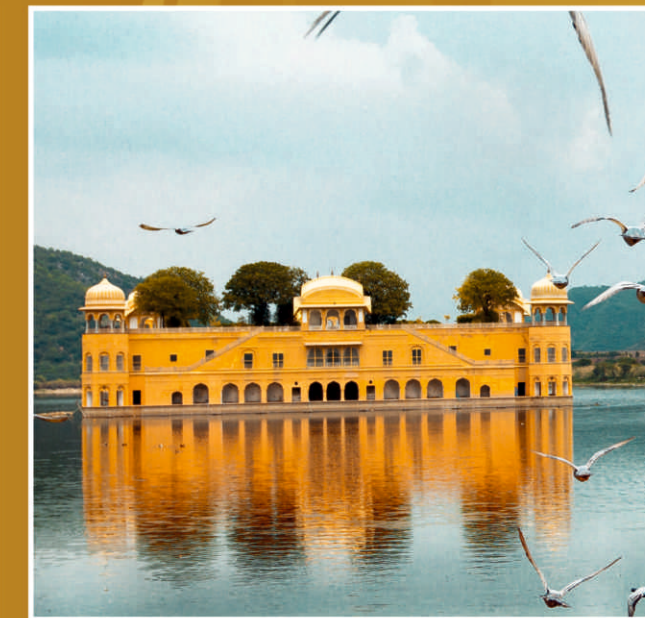
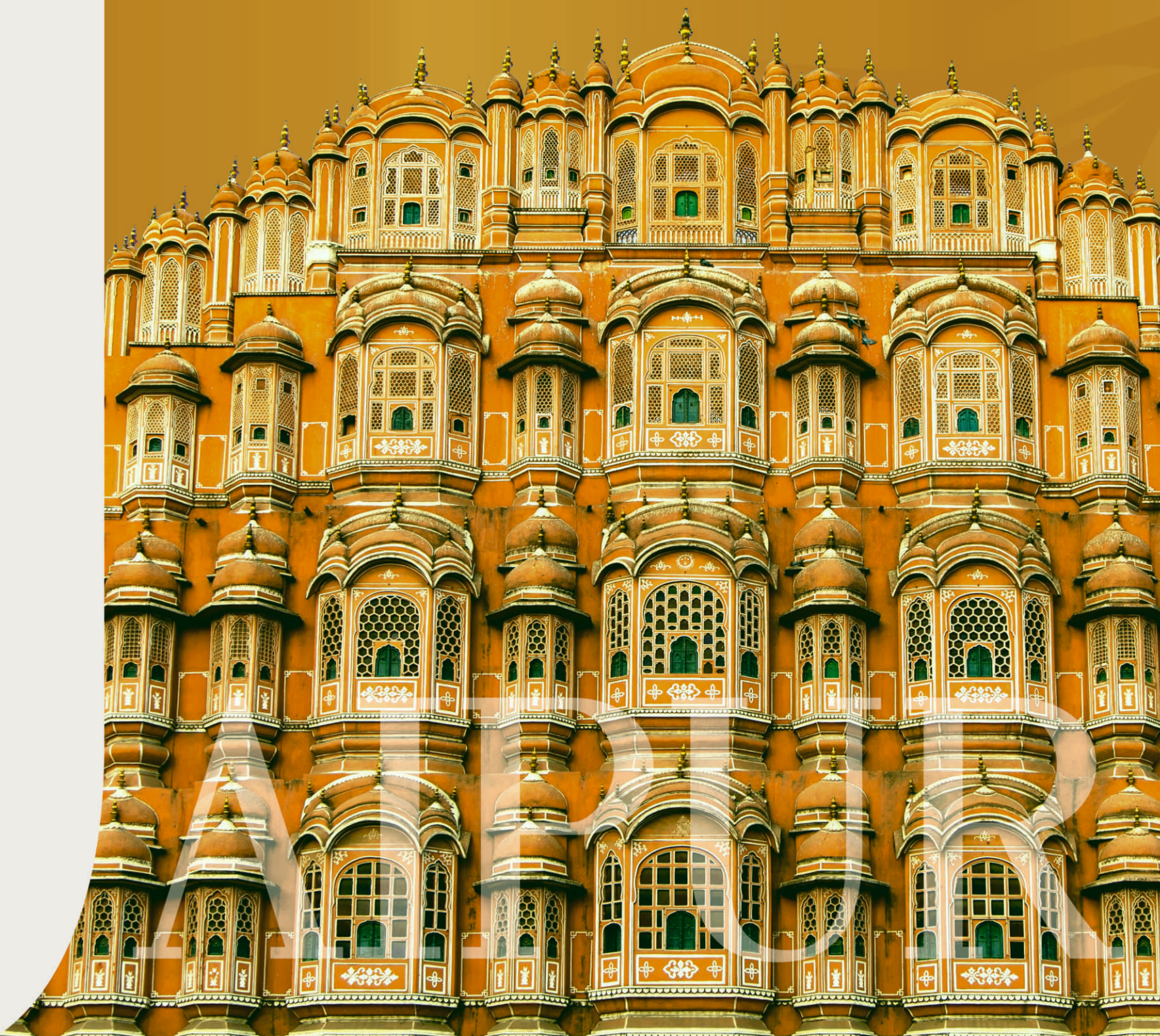

Jaipur, the capital city of Rajasthan, is renowned for its rich heritage and is strongly connected to history. Every time, the city has mesmerized everyone with its exceptional beauty, profound legacy, and immense growth.

Popularly known as the 'Pink City', you'll be amazed by the kind of luxurious living and royal lifestyle that people enjoy in Jaipur. You can witness an ever-growing and extensive luxury home segment at Jaipur.



“ EMBARK ON JOURNEY OF LUXURY



PERFECT PLACE FOR ENDLESS HAPPINESS

We crave to deliver what we promise, and that's what we did. Whether it be royalty, luxurious living, comfort or security, there's no compromise. We have created the best of facilities and opulent comforts that enhance your experience. The excellent location, superior connectivity, and elite infrastructure makes Shivala one of the best and most promising structures of Jaipur.





RESIDENTIAL

Shivala Villas presents the Signature Style Life. It brings forth a lifestyle for those who have a fine taste for life and exclusivity. Step into a home that blends innovation with style creating contemporary spaces that are a class apart.

Discover a landscaped garden that encompasses a galore of recreation amenities. Elevate to the terrace level and experience a host of features that's beyond the earth. At **Shivala Villas**, live the signature life at the new peak of luxury.

COMMERCIAL

Envisioned as a utopia for every type of business, this place hosts all the right features and a matchless location to deliver prosperous business environs.

The business spaces have been created to suit the needs of each and every type of business. Whether you are a wholesaler, retailer or from the service sector, these commercial spaces offer you a plethora of benefits. With the clearly visible unlimited opportunities for growth, a step towards **Shivala Villas** is not a leap of faith, it's a leap towards a brighter future.

LOW RISE EDGE, OVER HIGH RISE

- SPEEDY POSSESSION
- SPEEDY OCCUPANCY
- LOW MAINTENANCE COST
- MORE SAFETY
- HIGHER RENTAL VALUE
- EASY RESALE
- HASSLE FREE PARKING
- EASY REACHABILITY





WORLD
CLASS
AMENITIES

DISCOVER
LIMITLESS
ENTERTAINMENT



- SWIMMING POOL
- KIDS PLAY AREA
- INDOOR GAMES
- AC GYMNASIUM
- EV PROVISION
- TEMPLE
- COMMERCIAL SHOWROOM
- RESTAURANT
- BANQUET HALL
- 7500 Sq. Ft. CLUB AREA
- SOLAR PROVISION

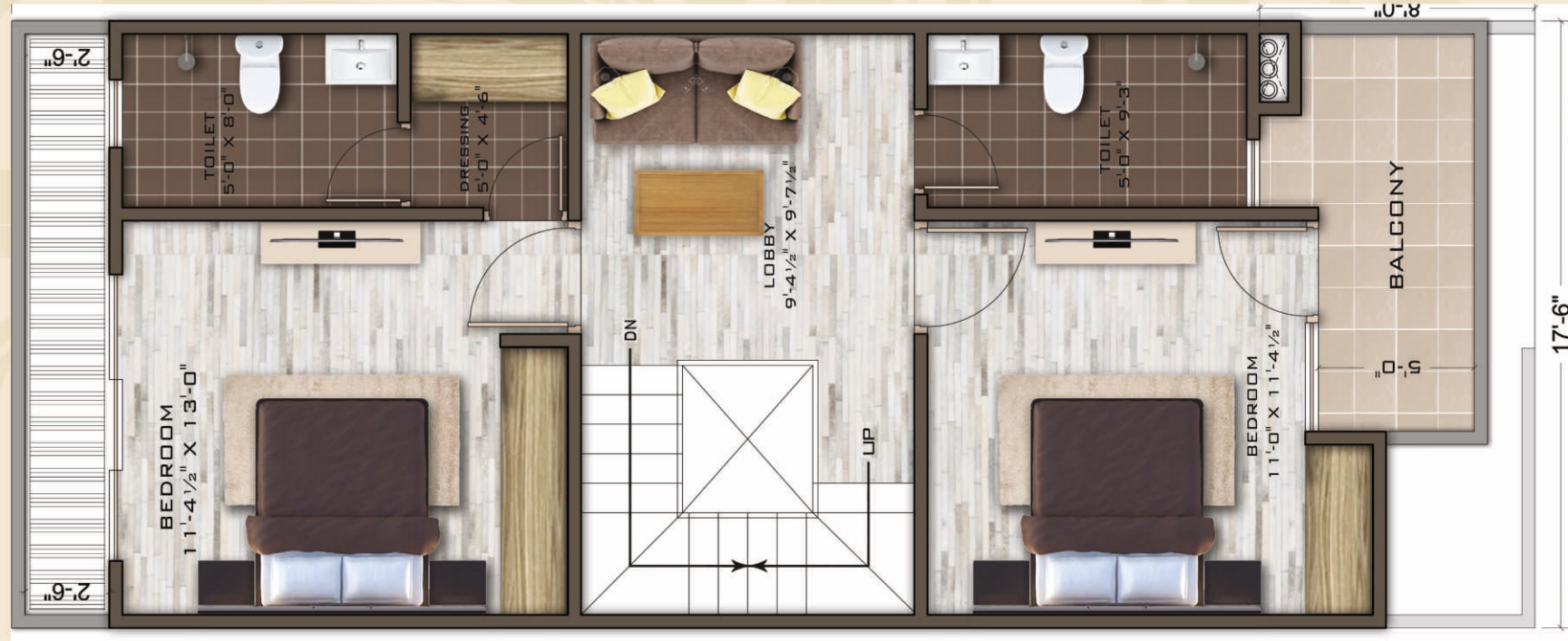
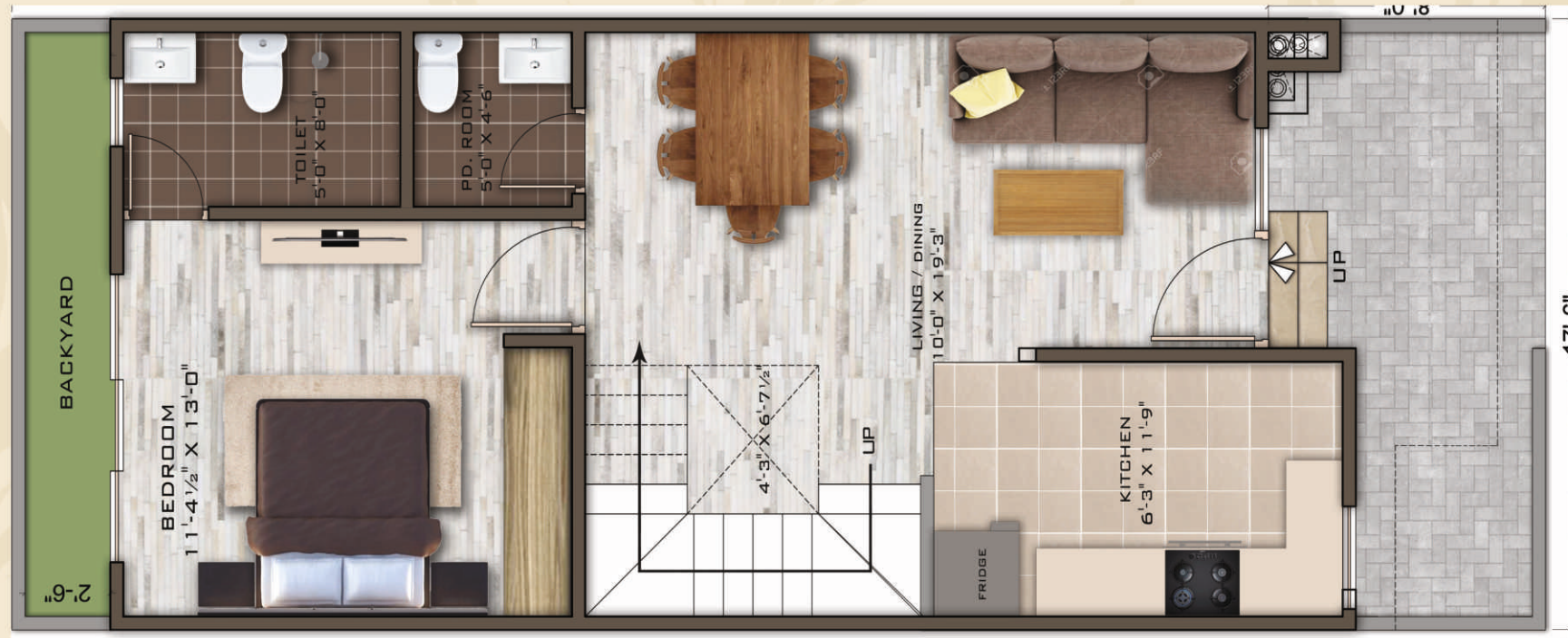

FLOOR PLAN

3 BHK DUPLEX VILLA

BUILD UP AREA
0000.00 SQf.ft

SALABLE AREA
0000.00 SQf.ft

BALCONY AREA
0000.00 SQf.ft

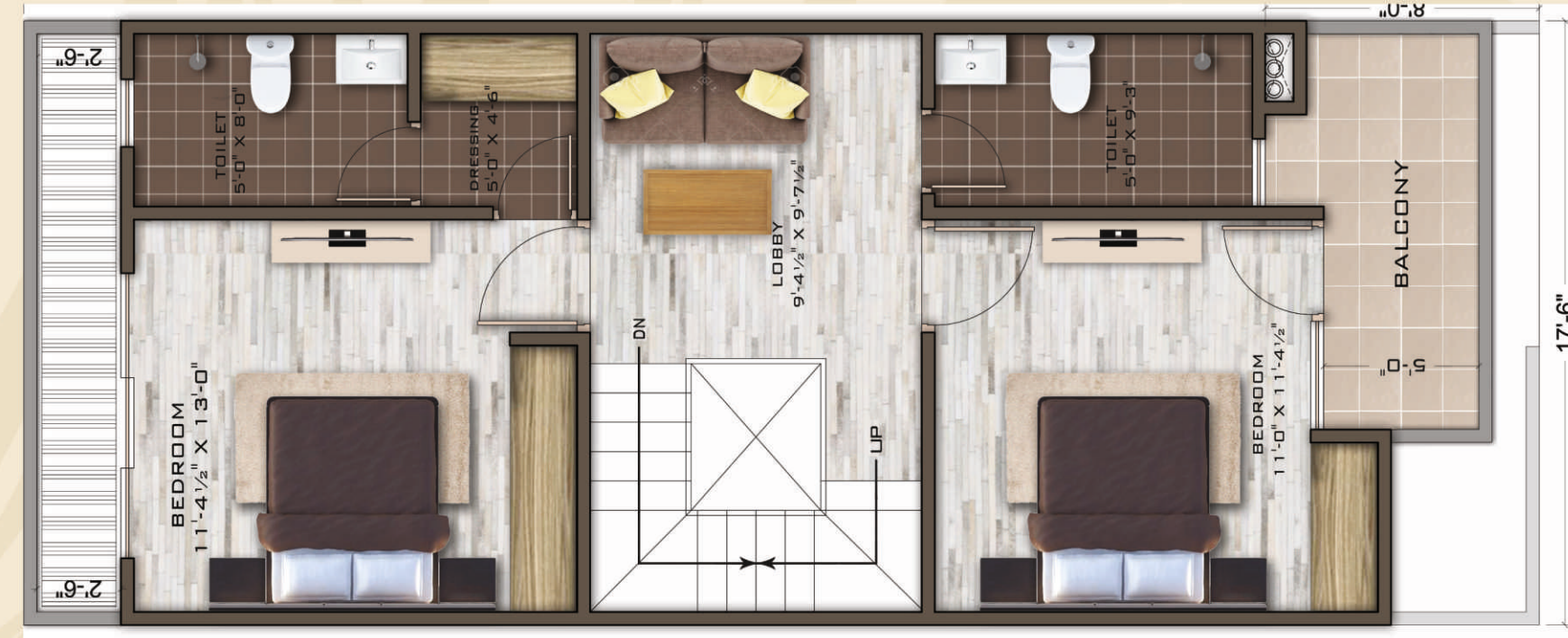
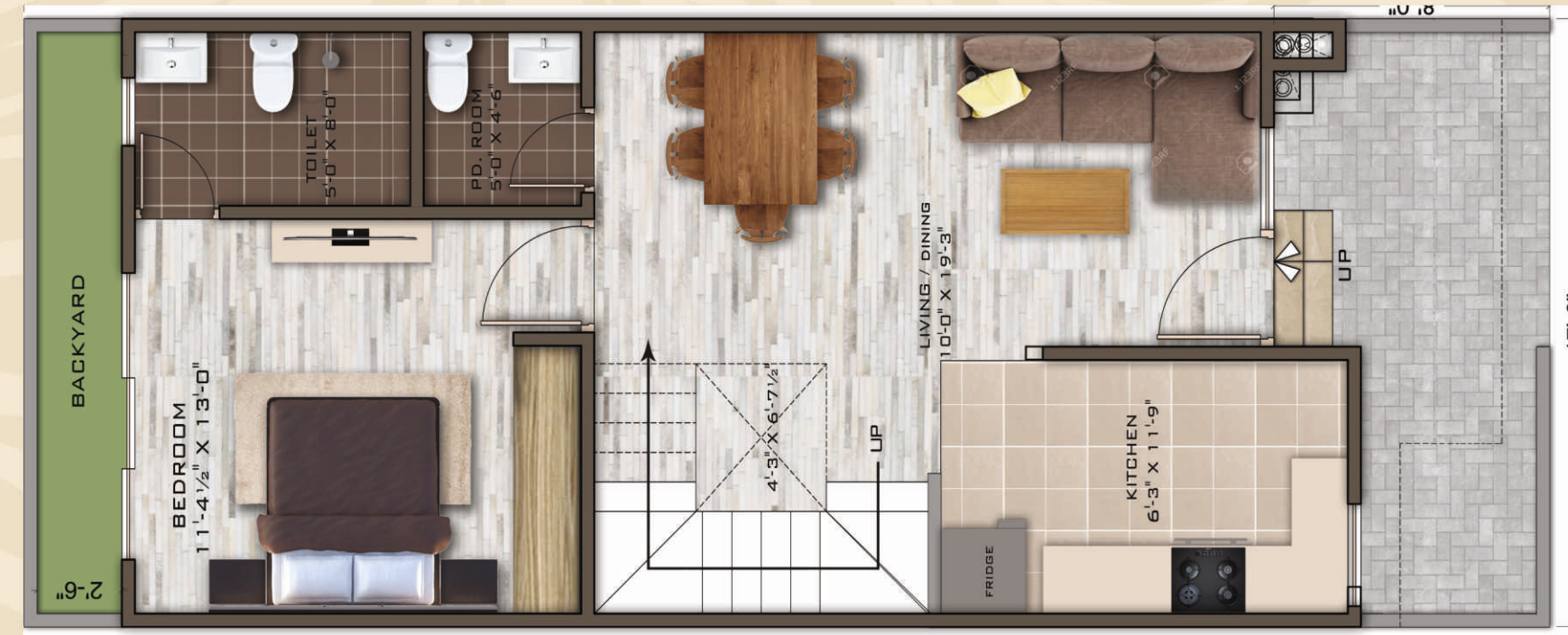

FLOOR PLAN

3 BHK DUPLEX VILLA

BUILD UP AREA
0000.00 SQf.ft

SALABLE AREA
0000.00 SQf.ft

BALCONY AREA
0000.00 SQf.ft

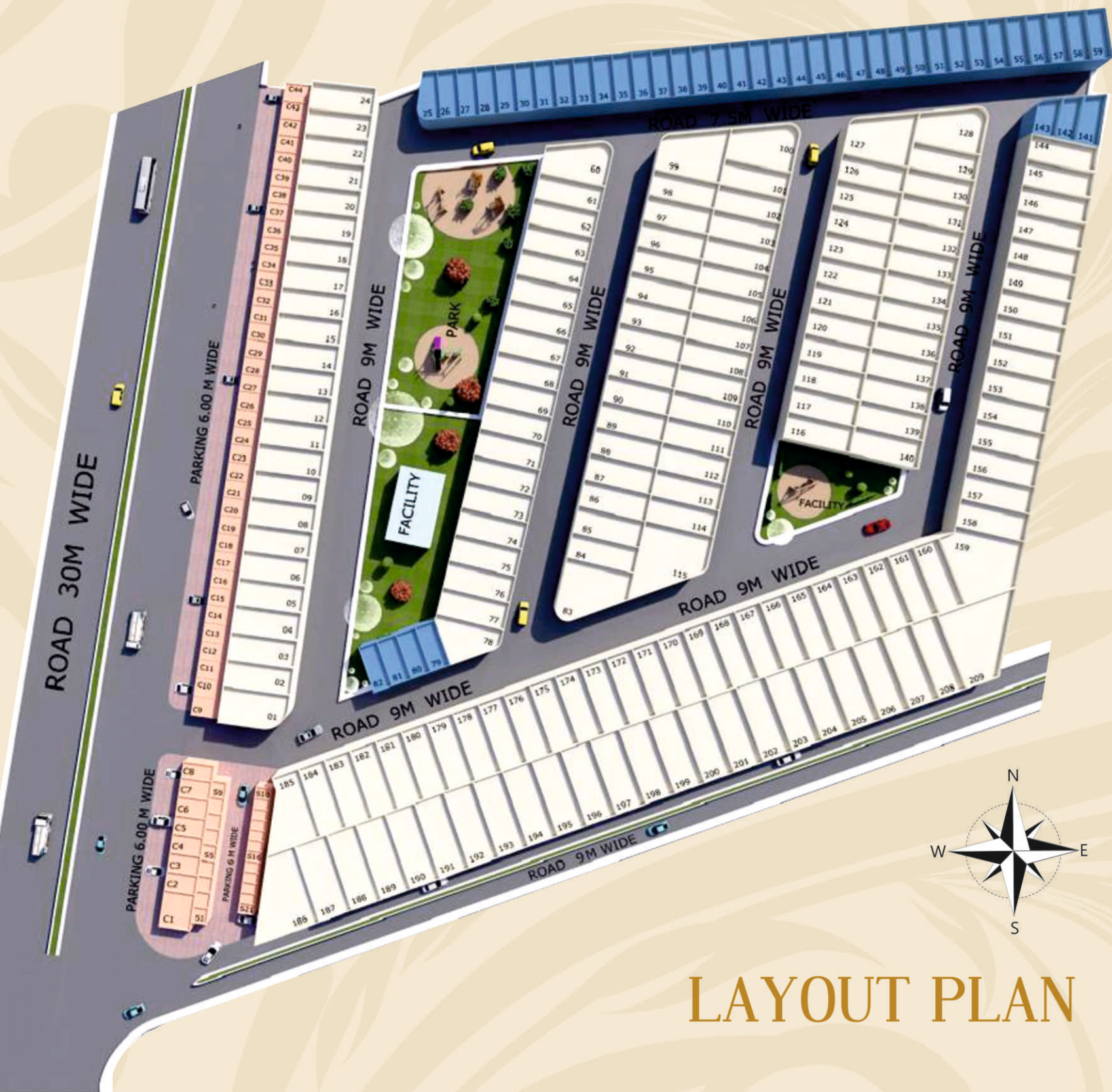

LAYOUT PLAN



SPECIFICATION

- RCC Framed Structure.
- Semi Modular Kitchen (Lower Cabinets only)
- Wardrobe in All bedrooms
- Provision for AC
- AC Pipeline in All rooms & Living area
- S. S. Railing in Stairs
- S.S Railing in Balcony with Toughen Glass
- 7 feet Height doors, Both side Laminated
- UPVC/Aluminum Window
- UG Tank and Separate Overhead water tank for Kitchen and bathroom
- Vitrified tile in Villas and Wooden Pattern vitrified in Master bed room
- Granite counter in Kitchen Platform
- EV Charging provision at villa entrance gate
- Solar Provision
- Wallpapers in Drawing and Living area
- 7 ft. Wall tiles in Bathrooms
- Anti-Skid tiles in Bathrooms
- Tullu Pump
- 3 Phase electric connection 5KV

MATERIAL USED IN SHIVALA PROJECT

Cement : Wonder, Ultratech or Shree	Sanitary Fitting : Jaquar, Hind ware or Equal ant	Electrical : Polycab, Anchor, RR ,Havells.	Vitrified Tile : 2x4 Size
Sand : Banaas	Plumbing : Astral	Electric Switch : Havells, Anchor	Paint : OBD, Branded Asian , Burger, Tractor or Birla
Steel : Premier, Rath, Jindal	Bricks : Hanumangarh Bricks	Windows : UPVC/ Aluminium with Toughened Glass	Wallpapers
Concrete : Ready-mix	Structure : RCC Frame	Doors : Flush Doors and Dual side Laminated	Papdiwala AC Wiring



PROJECT FEATURES



24*7 SECURITY (3 TIER) | GATED SOCIETY | WIDE ROADS | PARK (1550 SQ. YD.) | TEMPLE | RAIN WATER HARVESTING SYSTEM
SWIMMING POOL | STP | UNDERGROUND ELECTRIC POLES FOR COMMON AREA | COMMON AREAS ELECTRICITY | EASY APPROACH
THOUGHTFULLY DESIGNED LANDSCAPED | VASTU FRIENDLY PROJECT DESIGNED

LOCATION MAP



NOT TO SCALE

LOCATION ADVANTAGE



AIRPORT
25 km.



200ft.BUS STAND
8 km.



METRO STATION
8 km.



VAISHALI NAGAR
12 km.



MAHINDRA SEZ
2 km.



DPS SCHOOL
5 km.

JAIPUR AJMER NH-8 HGHWAY - 500 MTR
MANIPAL UNIVERSITY - 5 KM
MEDICAL COLLEGE & HOSPITAL -1.5 KM



PARSHVANATH

Limitless Luxury

Address : Opp. Siddha Aangan, GH -06, Omaxe City, Jaipur (Raj.) -302026

E-mail : info@parshvanathrealty.com | Web : www.parshvanathrealty.com



SCAN FOR LOCATION

For more enquiry call :

Disclaimer: *The information contained in this brochure is subject to change as may be approved by the competent authorities and cannot form part of any form or contract. * All plans are subject to any amendments approved by the competent authorities. *This Brochure shall not be treated as a legal document; It is only for information. * The isarea indicative only. The measurements indicated in the plan may vary at the time of construction. *The developer reserves all the right to make any change as may be necessitated from time to time in the layout, building plan, and specifications without any prior notice. Such changes would be binding to all members